

POWER ROD 131

The Cebora Power ROD 131 is a 130 amp, 230v DC power source incorporating the very latest generator compatible PFC inverter technology. It allows MMA welding with up to 3.25mm rutile basic electrodes and can perform DC TIG welding utilising the exceptional Cebora LIFT system.

The Power ROD 131 is distinguished by its shockproof casing and eye-catching design. It is a highly portable machine and is ideal for all light fabrication and maintenance applications in Mild and Stainless steels.



Part No. ART 256

Options:
TIG Torch
Earth Return
MMA Lead

Technical Specification	
Power Supply (+15%/-20%)	230V 1Ph
Fuses A	T16
Regulation Field in MMA/ TIG	10-130A
MMA/ TIG Duty Cycle @ 30%	130A
MMA Electrode Size	1.6-3.2MM
Protection Class	IP23S
TIG Ignition	LIFT
Weight	4.5 Kg

POWER ROD 1535

The Cebora Power ROD 1535 is a 150 amp, 230v DC power source incorporating the very latest generator compatible PFC inverter technology. It allows MMA welding with up to 4.0mm rutile basic electrodes and can perform DC TIG welding utilising the exceptional Cebora LIFT system.

With its robust design and protection device for connection to incorrect voltage supply, the power ROD 1535 is the perfect solution for all light to medium applications on a wide variety of materials.



Part No. ART 257

Options:
TIG Torch
Earth Return
MMA Lead

Technical Specification	
Power Supply (+15%/-20%)	230V 1Ph
Fuses A	T16
Regulation Field in MMA/ TIG	5-150A
MMA/ TIG Duty Cycle @ 35%	150A
MMA Electrode Size	1.6- 4.0MM
Protection Class	IP23S
TIG Ignition	LIFT
Weight	9 Kg

POWER ROD 1840

The Cebora Power ROD 1840 is a 180 amp, 230v DC power source incorporating the very latest generator compatible PFC inverter technology. It allows MMA welding with up to 4.0mm rutile basic electrodes and can perform DC TIG welding utilising the exceptional Cebora LIFT system.

The flexibility of this industrial power source is complemented by the Hot Start and Arc Force features allowing for professional adjustment of the welding output and with the possibility to connect a remote current control pendant.

The Cebora power ROD 1840 is the ideal solution for all medium fabrication applications on a wide selection of Mild steel and Stainless steel materials.



Part No. ART 261

Options:
TIG Torch, Earth Return, MMA Lead, Remote Control (Art 187)
5 Metre extension cable for ART 187 (ART 1327)
Foot Control Pedal c/w 5 Metre cable (Art 181)
Adaptor to attach foot control & TIG Torch (Art 1180)

Technical Specification	
Power Supply (+15%/-20%)	230V 1Ph
Fuses A	T16
Regulation Field in MMA/ TIG	10-180A
MMA/ TIG Duty Cycle @ 40%	180A
MMA Electrode Size	1.6- 4.0MM
Protection Class	IP23S
TIG Ignition	LIFT
Weight	9 Kg

SOUND MMA 2336/T

The Cebora Sound MMA 2336/T is a 230 amp, 400v DC power source incorporating the very latest generator compatible PFC inverter technology. It allows MMA welding with up to 5mm rutile basic electrodes and is suitable for DC TIG and DC PULSED TIG welding utilising the exceptional Cebora LIFT system.

The flexibility of this industrial power source is complemented by the addition of several industrial features including, digital ammeter, Hot Start, Arc Force and the possibility to attach a remote control pendant. The Cebora sound MMA 2336/T is the perfect solution for all industrial applications on a wide variety of materials.



Part No. ART 328

Options:
TIG Torch, Earth Return, MMA Lead,
Remote Control (Art 187)
5 Metre extension cable for ART 187 (ART 1192)
Foot Control Pedal c/w 5 Metre cable (Art 181)
Trolley (Art 1653)

Technical Specification	
Power Supply (+10%/-10%)	400V 3Ph
Fuses A	T10
Regulation Field in MMA/ TIG	10-230A
MMA/ TIG Duty Cycle @ 35%	230A
MMA Electrode Size	1.6- 5.0MM
Protection Class	IP23S
TIG Ignition	LIFT
Weight	16 Kg

SOUND MMA 3536/T CELL

The Cebora sound MMA 3536/T CELL is a 350 amp 400v DC power source incorporating the very latest generator compatible PFC inverter technology. It allows MMA welding with up to 6mm rods on a wide selection of electrode types including basic rutile, Low Hydrogen and Cellulosic. The machine is also suitable for both DC TIG and DC PULSED TIG welding utilising the exceptional Cebora LIFT system.

The Cebora MMA3536/T CELL is the ultimate DC welding power source and is complimented by the addition of several features including, Hot Start, Arc Force, digital ammeter and the possibility to connect a remote control pendant. This unrivalled DC power source is the perfect answer to high quality premium fabrications in all sectors of industry.



Part No. ART 335

- Options :**
 TIG Torch, Earth Return, MMA Lead,
 Remote Control (Art 187)
 5 Metre extension cable for ART 187 (Art 1192)
 Foot Control Pedal c/w 5 Metre cable (Art 181)
 Trolley (Art 1656)

Technical Specification	
Power Supply (+10%/−10%)	400V 3Ph
Fuses A	T16
Regulation Field in MMA/ TIG	10-350A
MMA/ TIG Duty Cycle @ 35%	350A
MMA Electrode Size	1.6- 6.0MM
Protection Class	IP23S
TIG Ignition	LIFT
Weight	26 Kg

EVO 160M COMBI

The Cebora Evo 160M COMBI is an ultra-reliable 230v compact MIG/MAG power source, featuring the "no gas" facility making it possible to weld with either solid or flux core wires.

The Evo Combi 160 M is ideal for applications in the DIY, maintenance, automotive and light fabrication industries.

Technical Specification	
Power Supply (+10%/−10%)	230V 1Ph
Fuses A	T16
Regulation Field	28-160A
Duty Cycle @ 20%	120A
Protection Class	IP21S
Weight	29 Kg

Part No. ART 495

- Package includes :**
 3 Metre MIG Torch,
 2 Metre Earth Return



Part No. ART 641

- Package includes:**
 Earth Return
Options :
 MIG Torch
 GRV8 Water Cooling unit (Art 1680)
 Updating kit for software/Synergic programs (ART 136)

EVO 350 TC COMPACT SYNERGIC

The EVO SYNERGIC 350 TC is a technologically advanced compact MIG/MAG welding machine featuring a heavy-duty power source equipped with a robust 4-roll wire feed system. This machine includes a full range of built in synergic programs to suit all materials, the fine tuning of the welding parameters is achieved through the adjustment of the Synergic control.

The exceptional welding characteristics given by this machine allow for welds to be produced to the highest industry standards.

Technical Specification	
Power Supply (+10%/−10%)	400V 3Ph
Fuses A	T25
Regulation Field	35-400A
Duty Cycle @ 40%	350A
Protection Class	IP21S
Weight	95 Kg

- Features :**
 4 roll feeder, Synergic mode, MIG brazing, Hot start,
 15 kilo spool holder, 2T/AT, Spot welding, Stitch welding,
 Soft start, Pre/ Postgas, Burn back, Adjustable choke,
 PFC compliant (EN-61000-3-12)



MIG/MAG

EVO 350 TS SYNERGIC

The Cebora EVO SYNERGIC 350TS is a technologically advanced MIG/MAG machine with Synergic control. These exceptional Power sources features a 4 roll wire feed system and built in synergic curves for all popular materials including Mild Steels, Stainless Steels and Aluminium.

Cebora EVO Synergic machines also benefit from a user friendly control panel allowing simple Synergic adjustment of all welding parameters. EVO Synergic machines from Cebora are industrial power sources designed to operate in any industrial fabrication or manufacturing environment.

Technical Specification	
Power Supply (+10%/-10%)	400V 3Ph
Fuses A	T25
Regulation Field	35-400A
Duty Cycle @ 40%	350A
Protection Class	IP21S
Weight	90 Kg

Features :
 4 roll feeder, Synergic mode, MIG brazing, Hot start,
 15 kilo spool holder, 2T/4T, Spot welding, Stitch welding,
 Soft start, Pre/ Postgas, Burn back, Adjustable choke,
 PFC compliant (EN-61000-3-12)



Part No. ART 643/1662

Package includes:
 Earth Return

Options :
 MIG Torch,
 5 Metre Interconnecting cables (Art 1182)
 10 Metre Interconnecting cables (Art 1182.20)
 GRV8 Water Cooling unit (Art 1680)
 Updating kit for software/Synergic programs
 (ART 136)



Part No. ART 647/ 1662

Package includes:
 Earth Return

Options :
 MIG Torch
 5 Metre Interconnecting cables (Art 1182)
 10 Metre Interconnecting cables (Art 1182.20)
 GRV8 Water Cooling unit (Art 1680)
 Updating kit for software/Synergic programs
 (ART 136)

E-mail: sales@weldfastuk.co.uk

Web: www.weldfastuk.co.uk



MIG/MAG

MONO STAR 1620/M SYNERGIC

The Cebora Mono Star MIG 1620/M SYNERGIC is a latest technology PFC electronic power source featuring synergic control. This highly portable machine offers an excellent range of standard and optional synergic programmes and can accommodate both solid and flux cored wires for a wide variety of welding applications.

The machine benefits from a high-resolution operator friendly LCD control panel giving complete control over all welding parameters. It is the perfect solution for use in the automotive repair, maintenance and light fabrication sectors.



Part No. ART 304

Package includes:
 Earth Return

Options :
 MIG Torch, Trolley (Art1653)
 Synergic programme upgrade (Art266)

Technical Specification	
Power Supply (+15%/-20%)	230V 1Ph
Fuses A	T16
Regulation Field	20-160A
Duty Cycle @ 20%	160A
Protection Class	IP23S
Weight	11 Kg

Features :
 2 roll feeder, Synergic mode, MIG brazing, Flux cored welding,
 Hot start, 5 kilo spool holder, 2T/4T, Spot welding, Stitch welding,
 Soft start, Burn back, Adjustable inductance,
 PFC compliant (EN-61000-3-12)

Telephone: 01782 566553

Fax: 01782 566123



synergic pulse

SYNSTAR 200M SYNERGIC

The Cebora Synstar 200M inverter based MIG/MAG welding power sources offer the perfect solution to a wide range of applications where Synergic and Pulse Synergic processes are required. These latest technology power sources provide exceptional welding performance and with the flexibility of software upgrade to include Pulse MIG/MAG welding and to connect the Cebora Push-Pull torch system, outstanding results are achieved even when using small diameter Aluminium wires.

The Cebora Synstar200M is designed for operation in all sectors of industry, including Automotive, light fabrication and general manufacture.

Technical Specification	
Power Supply (+20%/±20%)	230V 1Ph
Fuses A	T16
Regulation Field	20- 200A
MIG Duty Cycle @ 20%	200A
Protection Class	IP23S
Weight	45 Kg

Features :

2 roll feeder, Synergic mode, MIG brazing, Flux cored welding, Ready for Air cooled push pull torch, Hot start, Automatic hot start, 15 kilo spool holder, 2T/4T, Spot welding, Stitch welding, Soft start, Crater fill, Pre/ Postgas, Burn back, Adjustable inductance, PFC compliant (EN-61000-3-12)



Part No. ART 322

Package Includes :
2 Metre Earth Return

Options:
MIG Torch, Pulse Upgrade (Art238)
4 Metre Air cooled Push Pull Torch (Art2003)
Aluminium Welding Kit (Art 1933)



Part No. ART 323

Package Includes :
2 Metre Earth Return

Options:
MIG Torch, Pulse Upgrade (Art238)
4 Metre Air cooled Push Pull Torch (Art2003)
GRV14 Water Cooler (Art1681)

E-mail: sales@weldfastuk.co.uk

Web: www.weldfastuk.co.uk



synergic pulse

SYNSTAR 270T SYNERGIC

The SYNSTAR 270T is a 400v technologically advanced compact power source incorporating the very latest energy efficient inverter technology. This machine features MIG, MAG, PULSE (optional) with complete synergic control allowing the operator simple and efficient control of all welding parameters.

The flexibility of this machine can be further enhanced by the connection of the Cebora 2003 push-pull torch, ideal for trouble free wire feeding of small diameter soft wires. The user friendly LCD panel gives easy access to all the main and background welding parameters. It also benefits from a dynamic 4 roll wire feed system and a selection of popular synergic programs for use on a wide variety of materials.

Technical Specification	
Power Supply (+15%/±20%)	415V 3Ph
Fuses A	T16
Regulation Field	20- 270A
Duty Cycle @ 20%	270A
Protection Class	IP23S
Weight	50 Kg

Features :

4 roll feeder, Synergic mode, MIG brazing, Air cooled push pull torch, Hot start, Automatic hot start, 15 kilo spool holder, 2T/4T, Spot welding, Stitch welding, Soft start, Crater fill, Pre/ Postgas, Burn back, Adjustable inductance, PFC compliant (EN-61000-3-12)



Part No. ART 324

Package Includes :
2 Metre Earth Return

Options:
MIG Torch, Pulse Upgrade (Art238)
4 Metre air cooled Push Pull Torch (Art2003)
GRV14 Water Cooler (Art1681)



Part No. ART 386

Package Includes :
3 Metre Earth Return

Options:
MIG Torch, TIG Torch, GRV14 Water cooling unit (Art1681)
4 Metre Air cooled Push Pull Torch (Art2003)
6 Metre Water cooled Push Pull Torch (Art2008)
Upgraded to Pulsed TIG Function (Art234)

Telephone: 01782 566553 Fax: 01782 566123

SYNSTAR 330TS SYNERGIC PULSE/DOUBLE PULSE

The SYNSTAR 330TS is a technologically advanced multi-process welding system incorporating the very latest in energy efficient inverter technology. This machine features MIG PULSE, MIG double PULSE, MMA and TIG DC (with lift) as standard and the option to include a water cooler to further enhance the durability. It also includes a dynamic 4 roll separate wire drive system offering complete synergic adjustment for all welding parameters, allowing the operator full and accurate control over the selected welding process.

This machine benefits from a highly visible LCD touch screen display and a comprehensive range of popular synergic programs designed to produce outstanding results on a wide variety of materials in all areas of industry.

Technical Specification	
Power Supply (+15%/±20%)	400V 3Ph
Fuses A	T16
Regulation Field in MIG/ TIG/ MMA	15 - 330A
MIG/ TIG/ MMA Duty Cycle @ 40%	330A
TIG Ignition	LIFT
Protection Class	IP23S
Weight	82 Kg

Features :

- 4 Roll Feeder, Pulsed MIG Welding, Double Pulsed MIG Welding, Synergic Mode, Software Updates, Ready for Air cooled Push Pull torch, MIG brazing, DC TIG welding, DC MMA welding, 15 kilo spool holder, Hot Start, Suitable for Flux cored wire, 2T/4T, Spot welding, Stitch Welding, Soft Start, Crater Fill, Pre/Post gas, Burnback, Adjustable inductance, 3L three levels, PFC compliant (EN-61000-3-12)



Part No. ART 388

Package Includes :
2 Metre Earth Return

Options:

- MIG Torch, TIG Torch, GRV14 Water cooling unit (Art1681)
- 4 Metre Air cooled Push Pull Torch (Art2003)
- 6 Metre Water cooled Push Pull Torch (Art2008)
- Upgrade to Pulsed TIG Function (Art234)
- Wireless Auto-darkening filter for welding Mask (Art434)
- Welding Data Logger (Art408)
- Welding Data Interface Kit (Art429)
- 5 Metre Extension lead for data logger (Art2050)



Part No. ART 408

CEBORA EVO SPEED STAR

The EVO SPEED STAR from Cebora represents the ultimate in energy efficient inverter based multi process power sources, offering a wide selection of professional welding processes to accommodate all sectors of industry. The machines are supplied as standard with the following welding processes, MIG/MAG, MIG Synergic, High Deposit, TIG and MMA, the software can then, if required, be upgraded to include MIG PULSE, MIG double PULSE, TIG PULSE and Double level welding.

EVO SPEED STAR from Cebora are designed to work in any working sector where ultimate quality, performance and reliability are required, these include, aerospace, petrochemical and premium fabrication.



380 TC

Package Includes :

- 3 Metre Earth Return

Options :

- MIG Torch, TIG Torch, Pulse Upgrade for MIG (Art231)
- Double Pulse Upgrade for MIG (Art233)
- Pulse Upgrade for TIG (Art234)
- GRV12 Water Cooler (Art1683)
- 6 Metre Push Pull Torch Water Cooled (Art2008)
- 10 Metre Push Pull Torch Water Cooled (Art 2008,10)
- Push Pull Interface Kit (Art 106)



380 TS / 520 TS

Package Includes :

- 3 Metre Earth Return
- 1.5 Metre Interconnecting Cables (Art 1197,10)

Options:

- MIG Torch, TIG Torch, 5 Metre Interconnecting Cables (Art1197), 10 Metre Interconnecting cables (Art1197,20), Pulse Upgrade for MIG (Art231), Double Pulse Upgrade for MIG (Art233)
- Pulse Upgrade for TIG (Art234), GRV12 Water Cooler (Art1683), 6 Metre Push Pull Torch Water Cooled (Art2008), 10 Metre Push Pull Torch Water Cooled (Art 2008,10)
- Push Pull Interface Kit (Art 106), HF Unit (Art471)

Technical Specification		380 TC	380 TS	520 TS
Part No.	ART 318	ART 318	ART 319	ART 320
Power Supply (+15%/±20%)	400V 3Ph	400V 3Ph	400V 3Ph	400V 3Ph
Fuses A	T20	T20	T20	T40
Regulation Field in MIG/ TIG/ MMA	10- 380A	10- 380A	10- 380A	10- 520A
MIG/ TIG Duty Cycle @ 40%	380A	380A	380A	500A
MMA Duty Cycle @ 40%	230A	230A	230A	500A
TIG Ignition	LIFT	LIFT	LIFT	LIFT
Protection Class	IP23S	IP23S	IP23S	IP23S
Weight	92 Kg	92 Kg	92 Kg	118 Kg

Features :

- 4 roll feeder, Flux cored welding, DC TIG welding, DC MMA welding, Synergic mode, MIG brazing, Hot start, Automatic hot start, High deposit function, Root function, 15 kilo spool holder, 2T/4T, Spot welding, Stitch welding, Soft start, Crater fill, Pre/ Post gas, Burn back, Adjustable inductance, PFC compliant (EN-61000-3-12)

POCKET PULSE

The POCKET PULSE MIG WELDER is the latest edition to the unique "pocket series" of welding and cutting machines from CEBORA of Italy. This revolutionary new, inverter based power source offers unrivalled PULSE synergic MIG welding in a lightweight, portable format from a 230v supply.

This machine sets a new benchmark in portable MIG welding standards and offers the operator unrivalled parameter adjustment and welding performance. The incredible POCKET PULSE MIG WELDER boasts a complete range of PULSE synergic programs for all materials suitable for a wide variety of applications.

Technical Specification	
Power Supply (+15%/+15%)	230V 1Ph
Fuses A	T16
Regulation Field	20- 185A
Duty Cycle @ 20%	185A
Protection Class	IP23S
Weight	13.5 Kg

Part No. ART 305

Package Includes :
3 Metre Earth Return

Options: MIG Torch



Part No. ART 301

Package Includes :
3 Metre Earth Return

Options:
MIG Torch
4 Metre Air cooled Push Pull Torch (Art2003)
Kit for 300mm reels (Art114)
Trolley for power source for use With Art114 (Art1656)

JAGUAR E 200 MD MIG

The Jaguar E 200/MD represents the very latest evolution of the Jaguar series of 230v inverter based synergic welding machines, allowing the connection of two torches and two materials at the same time. This machine is supplied with over 34 standard synergic programmes and with the optional PULSE upgrade, this extremely versatile welding machine can accommodate a wide variety of materials including Aluminium, MIG Brazing and High strength steels so is the perfect solution for high quality automotive repair applications.

The Jaguar E 200/MD is supplied with the latest in high resolution microprocessor control systems allowing the operator complete and seamless adjustment of all welding parameters. It has many unique attributes including industry approvals from some of the world's leading vehicle manufacturers.

Technical Specification	
Power Supply (+15%/+20%)	230V 1Ph
Fuses A	T16
Regulation Field	20- 200A
Duty Cycle @ 20%	200A
Protection Class	IP23S
Weight	68 Kg

Features :
2 x 2 roll wire feeders, MIG Brazing, Synergic mode, Software Updates, Ready for Air cooled Push pull torch, Hot start, 15Kg spool holder, 2T/4T, Spot welding, Stitch welding, Soft start, Crater fill, Pre/ Postgas, Burn back, Adjustable inductance, 3L, 3 Levels, PFC compliant (EN-61000-3-12)

JAGUAR SOUND MIG 2060/MD STAR DOUBLE PULSE

The Jaguar sound MIG Star Double PULSE is a technically advanced 230v inverter based synergic welding power source fitted with two wire feed systems allowing two welding torches to be connected at the same time for two different materials. This machine is supplied with over 60 synergic programmes covering a wide variety of materials including Aluminium, MIG Brazing and High strength steels making it the ideal solution for high quality automotive repair applications.

This extremely versatile welding machine comes with an operator friendly electronic control panel allowing full and accurate adjustment over all welding parameters. The Cebora Jaguar Sound MIG 2060/MD has many unique attributes including industry approvals from some of the world's leading vehicle manufacturers.

Technical Specification	
Power Supply (+15%/+20%)	230V 1Ph
Fuses A	T20
Regulation Field	15- 200A
Duty Cycle @ 60%	200A
Protection Class	IP23S
Weight	75 Kg

Features :
2 x 2 roll wire feeders, Double Pulse MIG welding, MIG Brazing, Synergic mode, Software Updates, Ready for Air cooled Push pull torch, Hot start, 15Kg spool holder, 2T/4T, Spot welding, Stitch welding, Soft start, Crater fill, Pre/ Postgas, Burn back, Adjustable inductance, 3L, 3 Levels, PFC compliant (EN-61000-3-12)



Part No. ART 321

Package Includes :
Earth Return

Options:
MIG Torch, Upgrade to Pulse Function (Art238)
4 Metre Air cooled Push Pull Torch (Art2003)
GRV12 Water cooler (Art1683)



Part No. ART 302

Package Includes :
Earth Return

Options:
MIG Torch
4 Metre Air cooled Push Pull Torch (Art2003)
GRV12 Water cooler (Art1683)

POWER TIG 1640 DC-HF

The Cebora power TIG 1640 DC-HF is a 230v power source incorporating the very latest inverter technology.

The Power TIG 1640 DC-HF is designed for welding a wide selection of materials including Mild Steels, Stainless Steels and Copper. The Cebora Power TIG 1640 DC-HF will accept a foot control or a remote control device adding flexibility to a small professional machine.

Technical Specification	
Power Supply (+15%/-20%)	230V 1Ph
Fuses A	T16
Regulation Field in TIG DC	5- 160A
Regulation Field in MMA	10- 140A
TIG Duty Cycle @ 40%	160A
MMA Duty Cycle @ 30%	140A
MMA Electrode Size	1.6- 3.2mm
Protection Class	IP23S
TIG Ignition	HF/ LIFT
Weight	10.3 Kg

Features :
High frequency start, LIFT start mode, 2T/4T, Remote control, Slope down, Post gas, Suitable for Generator, MMA function, ARC force for MMA, Hot start, PFC compliant. (EN-61000-3-12)



Part No. ART 264

Options:
TIG Torch, Earth Return, MMA Lead, Trolley (Art1653), Remote Control (Art187), Extension cable for remote control (Art1192), Foot Control Pedal (Art193), Adaptor to attach foot control & TIG torch (Art1180)



Part No. ART 265

Options:
TIG Torch, Earth Return, MMA Lead, Trolley (Art1653), Remote Control (Art187), Extension cable for remote control (Art1192), Foot Control Pedal (Art193), Adaptor to attach foot control & TIG torch (Art1180)

Features :
Max.Pulse Frequency= 500Hz, High frequency start, LIFT start mode, 2T/4T, 2 Level 4 Time Mode, LIFT control, Slope up/ Slope down, Post gas, Job mode, Suitable for Generator, MMA function, ARC force for MMA, Hot start, PFC compliant (EN-61000-3-12)

E-mail: sales@weldfastuk.co.uk

Web: www.weldfastuk.co.uk

TIG SOUND DC 2341/T

The Cebora TIG sound DC 2341/T is a 400v DC power source incorporating the latest generator compatible inverter technology. The TIG sound DC2341/T benefits from a full function microprocessor control panel allowing full adjustment of all welding parameters.

The flexibility of this exceptional DC power source can be further enhanced with the addition of water cooler, a remote control pendant or a foot control pedal making it the perfect solution for a wide variety of industrial and fabrication applications.

Technical Specification	
Power Supply (+10%/-10%)	400V 3Ph
Fuses A	T10
Regulation Field in TIG DC	5- 230A
Regulation Field in MMA	10- 210A
TIG Duty Cycle @ 40%	230A
MMA Duty Cycle @ 60%	210A
MMA Electrode Size	1.6- 5.0mm
Protection Class	IP23S
TIG Ignition	HF/LIFT
Weight	16 Kg

Features :
Max.Pulse Frequency=500Hz, High frequency start, LIFT start mode, 2T/4T, 3 level TIG program, 2 Level/ 4 Level mode, Spot welding mode, Remote control, Slope up/ Slope down, Pre/ Post gas, Job mode, Ready for manual Plasma console, Suitable for generator, MMA function, ARC force for MMA, Hot start, PFC compliant (EN-61000-3-12)



Part No. ART 360

Options:
TIG Torch, Earth Return, MMA Lead, Trolley (Art1653), Trolley for Water cooling version (Art1656), GR53 Water cooling unit (Art1341), Remote control (Art187), Extension cable for remote control (Art1192), Foot Control Pedal (Art193), Adaptor to attach foot control & TIG torch (Art1180)



Part No. ART 362

Options:
TIG Torch, Earth Return, MMA Lead, Remote control (Art187), Extension cable for remote control (Art1192), Foot Control Pedal (Art193), Adaptor to attach foot control & TIG torch (Art1180)

Features :
Max.Pulse Frequency= 500Hz, High frequency start, LIFT start mode, 2T/4T, 3 level TIG program, 2 Level/ 4 Level mode, Spot welding mode, Remote control, Slope up/ Slope down, Pre/ Post gas, Job mode, Ready for manual Plasma console, Suitable for generator, MMA function, ARC force for MMA, Hot start, PFC compliant (EN-61000-3-12)

Telephone: 01782 566553 Fax: 01782 566123



Part No. ART 363

Options:
 TIG Torch, Earth Return, MMA Lead, Remote control (Art1187), Extension cable for remote control (Art11192) Foot Control Pedal (Art1193), Adaptor to attach foot control & TIG torch (Art1180)

Features : Max.Pulse Frequency= 2500Hz, High frequency start, LIFT start mode, Spot welding mode, 2T/4T, 3 level TIG program, 2 Level 4 Time mode, Remote control, Synergic parameters, Slope up/ down, Pre/ Post gas, Job mode, Ready for TIG cold wire feeder, Ready for automatic plasma welding console, Ready for connection to Robot, Panel lock, Suitable for generator, MMA function, ARC force for MMA, Hot start, Crater current adjustment, USB interface, RS232 interface, PFC compliant (EN-61000-3-12), Firmware update

Technical Specification	
Power Supply (+10%/-10%)	400V, 3Ph
Fuses A	T32
Regulation Field in TIG DC	5- 500A
Regulation Field in MMA	10- 380A
TIG Duty Cycle @ 60%	500A
MMA Duty Cycle @ 100%	380A
MMA Electrode Size	1.6- 6.0mm
Protection Class	IP23S
TIG Ignition	HF/LIFT
Weight	105 Kg

TIG DC EVO 500/T

The Cebora TIG EVO DC 500/T is a 400V, DC power source representing the very latest in industrial energy efficient inverter technology. The TIG DC EVO 500/T benefits from a highly visible and user friendly microprocessor control system allowing for the full adjustment of all welding parameters.

The Cebora TIG DC EVO 500/T is a water cooled DC TIG welding system offering unrivalled quality and performance and can be further enhanced with the integration of the Cebora Plasma Welding console (ART 476.50) and with the addition of a foot pedal or remote control pendant it is the perfect solution for all industrial applications including petrochemical, aerospace and industrial fabrication.

TIG SOUND AC-DC 1531/M

The Cebora TIG sound AC-DC 1531/M is a highly portable 230v power source incorporating the very latest in energy efficient inverter technology. The TIG sound AC-DC 1531/M is equipped with a clear, user friendly digital control panel offering complete adjustment of all welding parameters including Pulse, frequency control, slope and gas times etc.

The flexibility of this excellent generator compatible power source can be further enhanced by the addition of either a foot control or remote control device making it the ideal solution for a wide range of applications including Maintenance, repair and small production fabrications on all materials.

Technical Specification	
Power Supply (+15%/-20%)	230V 1Ph
Fuses A	T16
Regulation Field in TIG	5- 150A
Regulation Field in MMA	10- 130A
TIG Duty Cycle @ 30%	150A
MMA Duty Cycle @ 30%	130A
MMA Electrode Size	1.6- 3.2mm
Protection Class	IP23S
TIG Ignition	HF/LIFT
Weight	18 Kg

Options:
 TIG Torch, Earth Return, MMA Lead, Trolley (Art1653), Remote control (Art1187), Extension cable for remote control (Art11192) Foot Control Pedal (Art1193), Adaptor to attach foot control & TIG torch (Art1180)

Features : Max.Pulse Frequency= 500Hz, High frequency start, LIFT start mode, Spot welding mode, 2T/4T, Min. set current TIG AC= 5A, Max. AC frequency= 150Hz, AC horizontal balance, Remote control, Slope up/ Slope down, Pre/ Post gas, Suitable for generator, MMA function, ARC force for MMA, Hot start, PFC compliant (EN-61000-3-12)



Part No. ART 364



Part No. ART 365

Options:
 TIG Torch, Earth Return, MMA Lead, GR53 Water cooling unit (Art1341) Trolley (Art1656), Remote control (Art1187), Extension cable for remote control (Art11192) Foot Control Pedal (Art1193), Adaptor to attach foot control & TIG torch (Art1180)

Features : Max.Pulse Frequency= 2500Hz, High frequency start, LIFT start mode, 2T/4T, 2 Level 4 Time mode, Min. set current TIG AC= 5A, Max. AC frequency= 150Hz, AC Horizontal balance, Current adjustment, Wave type selections, Remote control, Slope up/ down, Pre/ Post gas, Job mode, Spot welding mode, Crater current adjustment, Interface for cooling unit, Suitable for generator, MMA function, ARC force for MMA, Hot start, RS232 interface, PFC compliant (EN-61000-3-12), Firmware update

Technical Specification	
Power Supply (+15%/-20%)	230V 1Ph
Fuses A	T16
Regulation Field in TIG	5- 220A
Regulation Field in MMA	10- 180A
TIG Duty Cycle @ 40%	220A
MMA Duty Cycle @ 30%	180A
MMA Electrode Size	1.6- 4.0mm
Protection Class	IP23S
TIG Ignition	HF/LIFT
Weight	22 Kg



TIG ac/DC

CEBORA TIG AC-DC EVO 260/T - 330/T - 450/T

The Cebora EVO AC-DC TIG welding machines are a range of inverter based power sources incorporating the latest Evolution in electronic inverter technology and manufactured to the highest European standards. The EVO AC-DC TIG welding machines are complimented by the full function microprocessor control panel giving total operator control of all welding parameters including, wave form, pulse, frequency, slope and gas times etc.

These innovative power sources also allow the user to operate in Synergic TIG mode, upon selection of the material, plate thickness and welding position the machine suggests the best welding condition. The flexibility of these premium TIG welding packages can be further enhanced by the addition of either a foot control or remote control device, making these machines ideal solutions for any industrial application on any material.

Water cooling is standard for the EVO 330/T and 450/T but is an optional extra for the 260/T.



260/T



330/T



450/T

260/T Options:

- TIG Torch, Earth Return, MMA Lead, GR12 Water cooling unit (Art1683)
- Remote control (Art187),
- Extension cable for remote control (Art1192)
- Foot Control Pedal (Art193), Adaptor to attach foot control & TIG torch (Art1180)

330/T & 450/T Options:

- TIG Torch, Earth Return, MMA Lead, Remote control (Art187),
- Extension cable for remote control (Art1192)
- Foot Control Pedal (Art193), Adaptor to attach foot control & TIG torch (Art1180)

Technical Specification	260/T	330/T	450/T
Part No.	ART 369	ART 370	ART 371
Power Supply (+10%/+10%)	400V 3Ph	400V 3Ph	400V 3Ph
Fuses A	T10	T20	T25
Regulation Field in TIG	5- 260A	5- 330A	5- 450A
Regulation Field in MMA	10- 210A	10- 330A	10- 360A
TIG Duty Cycle @100%	230A	310A	380A
MMA Duty Cycle @ 40%	@ 40% 210A	@ 40% 330A	@60% 360A
MMA Electrode Size	1.6- 5.0mm	1.6- 6.0mm	1.6- 6.0mm
Protection Class	IP23S	IP23S	IP23S
TIG Ignition	HF/LIFT	HF/LIFT	HF/LIFT
Weight	65 Kg	96 Kg	136 Kg

Features :

Water cooling, Max.Pulse Frequency= 2500Hz, High frequency start, High frequency start by EVO LIFT, LIFT start mode, Spot welding mode, 2T/4T, 2 Time & 4 Time mode, 3 level TIG program, Min. set current TIG AC= 5A, Max. AC frequency= 150Hz, Current adjustment, Wave type selections, Crater fill, Remote control, Slope up/down, Pre/ Post gas, Job mode, Panel locking, Horizontal balance, AC Vertical balance, Inertance for cooling unit, Ready for automatic Plasma console, Ready for hot/cold wire feed unit, Ready for connection to Robot, Mix TIG, Suitable for generator, MMA function, ARC force for MMA, AC/DC MMA welding, Hot start, USB Interface, RS232 interface, PFC compliant (EN-61000-3-12), Firmware update



PLASMA

POWER PLASMA 2025/M

The Cebora Power Plasma 2025/M is a 230v power source incorporating the very latest generator compatible inverter technology. This highly portable plasma cutter allows cutting on all metallic materials utilising the genuine Cebora CP41C hand torch.

The arc is initiated by the "on air" system and benefits from exceptional electromagnetic compatibility making it usable in the vicinity of electronic equipment, computers and PLC etc. The Cebora Power Plasma 2025/M is equipped with a 4-meter hand torch and air regulator and is the ideal solution for a wide range of applications.



Part No. ART 270

Package Includes :
4 Metre Cebora CP41C PLASMA cutting torch (Art 1209)
4 Metre Earth Return

Option:
Trolley (ART1653)

Recommended	Maximum	Severance	
Mild Steel	6mm	8mm	10mm
Technical Specification			
Power Supply (+15%/+20%)	230V 1Ph		
Fuses A	T10		
MMA Duty Cycle @ 25%	20A		
Current Range	5- 20A		
Operating Pressure	3.5 Bar		
Protection Class	IP23S		
Weight	9.4 Kg		
Generator Friendly	Yes		

CP41C PLASMA CUTTING TORCH SPARES

Part No.	Description
ART1209	Cebora CP41C MAR hand torch with direct connection. 4 metre long
ART1147	Body for hand torches
ART1291	Ø 0.7 mm nozzles (5 pieces)
ART1878	Electrodes (5 pieces)
ART1641	Swirl rings (2 pieces)
ART1906	Nozzle holder
ART162	Wheeled compasses for CP41C MAR hand torch art. 1209
ART157	Wheeled torch holder. For art. 162





PLASMA

POWER PLASMA 3035/M

The Cebora Power Plasma 3035/M is a 110v/230v power source incorporating the very latest generator compatible inverter technology. This highly flexible plasma cutter is supplied with the genuine Cebora CP40 hand torch and uses high voltage arc striking, ensuring reliable lighting of the pilot arc and benefits from exceptional electromagnetic compatibility allowing use in the vicinity of computers, PLC and electronic equipment etc.

The Cebora power plasma 3035/M is the perfect solution to applications in the automotive, maintenance and light fabrication sectors.



Part No. ART 359

Package Includes :
6 Metre Cebora CP101 Plasma cutting torch (Art 1220.20)
6 Metre Earth Return

Options :
Trolley (Art 1656)
12 Metre CP101 Plasma cutting torch (Art 1220.20)
6 Metre CP161 Profile machine torch (Art 1231)
12 Metre CP161 Profile machine torch (Art 1231.20)
Interface kit for Machine torch (Art 196)

Recommended	Maximum	Severance
Mild Steel 8mm	12mm	15mm
Technical Specification		
Power Supply (+15%/-20%)	110V/230V 1Ph	
Fuses A 110V	T32	
Fuses A 230V	T16	
Duty Cycle @ 35%	30A	
Current Range	5- 30A	
Operating Pressure	3.5 Bar	
Protection Class	IP23S	
Weight	13 Kg	
Generator Friendly	Yes	

POWER PLASMA 6061/T

The Cebora Power Plasma 6061/T is a 400v power source incorporating the very latest generator compatible inverter technology. This excellent industrial plasma cutter allows cutting on all metallic materials and is supplied with the genuine Cebora CP101 hand torch and benefits from high electromagnetic compatibility allowing use in electronically sensitive areas.

This technologically advanced power source is the ideal solution for a wide selection of industrial and fabrication applications.

Recommended	Maximum	Severance
Mild Steel 20mm	25mm	30mm
Technical Specification		
Power Supply (+10%/-10%)	400V 3Ph	
Fuses A	T10	
Duty Cycle @ 60%	60A	
Current Range	20- 60A	
Operating Pressure	5 Bar	
Protection Class	IP23S	
Weight	26 Kg	
Generator Friendly	Yes	



PLASMA

CP40 PLASMA CUTTING TORCH SPARES

Part No.	Description
ART1206	Cebora CP40 MAR hand torch with direct connection. 4 metre long
ART1207	Cebora CP40 DAR torch for profile machine, with direct connection. 6 metre long
ART1207.20	Cebora CP40 DAR torch for profile machine, with direct connection. 12 metre long
ART1136	Body for hand torches
ART1347	Body for profile torches
ART1290	Ø 0.7 mm nozzles (5 pieces)
ART1516	Electrodes (5 pieces)
ART1507	Swirl rings (2 pieces)
ART1900	Nozzle holder
ART162	Wheeled compasses for CP40 MAR hand torch Art 1206
ART157	Wheeled torch holder. For Art 162



CP101 PLASMA CUTTING TORCH SPARES

Part No.	Description
ART1220	Cebora CP101 MAR hand torch with central adaptor. 6 metre long
ART1220.20	Cebora CP101 MAR hand torch with central adaptor. 12 metre long
ART1146	Body for hand torches
ART1765	Ø 1.2 mm nozzles (5 pieces). Can be used between 20 and 60 Amp.
ART1368	Electrodes (5 pieces)
ART1958	Swirl rings (2 pieces)
ART1911	Nozzle holder
ART1404	Spacing bushes with 2 points (3 pieces)
ART163	Wheeled compasses for CP101 MAR hand torches art. 1220 - 1220.20
ART153	Wheeled torch holder for CP101 MAR torches art. 1220 - 1220.20

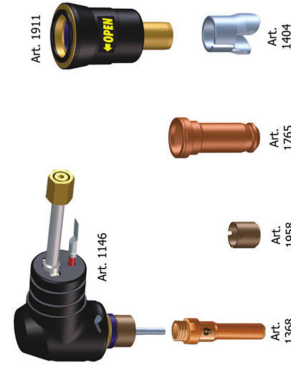

E-mail: sales@weldfastuk.co.uk

Web: www.weldfastuk.co.uk

Telephone: 01782 566553

Fax: 01782 566123



PLASMA



Part No. ART 361

- Package Includes :**
 6 Metre Cebora CP161 Plasma cutting torch (Art 1230)
 6 Metre Earth Return
- Options :**
 Wheel Kit (Art 1670)
 12 Metre CP161 Plasma cutting torch (Art 1230.20)
 6 Metre CP161 Profile machine torch (Art 1231)
 12 Metre CP161 Profile machine torch (Art 1231.20)
 Interface kit for Machine torch (Art 108)



Part No. ART 957

- Package Includes :**
 6 Metre Earth Return
- Options :**
 6 Metre CP161 Plasma cutting torch (Art 1230)
 12 Metre CP161 Plasma cutting torch (Art 1230.20)
 6 Metre CP161 Profile machine torch (Art 1231)
 12 Metre CP161 Profile machine torch (Art 1231.20)
 Interface kit for Machine torch (Art 108)

E-mail: sales@weldfastuk.co.uk

Web: www.weldfastuk.co.uk



PLASMA

CP161 PLASMA CUTTING TORCH SPARES - For Manual Cutting

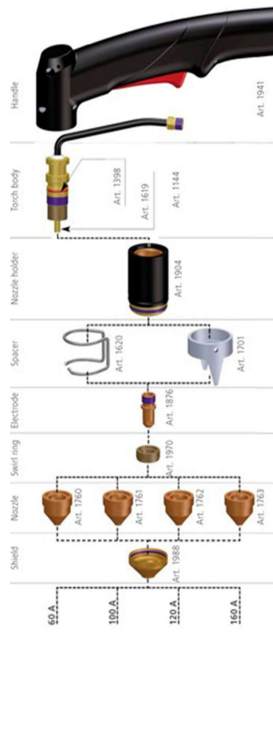

Part No. Description - Manual Cutting

ART1904	Nozzle holder
ART1970	Swirl Ring
ART1619	Brass Cooling Pipes (5 pieces)
ART1620	Spacing springs (5 pieces)
ART1701	Spacing bushes with 2 points (3 pieces)
ART407	Wheeled compasses for hand torches
ART406	Wheeled torch holder

Part No. Description - Manual Cutting

ART1230	Cebora CP161 MAR hand torch with central adaptor. 6 metre long
ART1230.20	Cebora CP161 MAR hand torch with central adaptor. 12 metre long
ART1144	Body for hand torches
ART1941	Handle assy
ART1398	O-rings (5 pieces)
ART1760	Ø 1,2 mm nozzles (5 pieces). Can be used between 40 and 60 Amp
ART1761	Ø 1,4 mm nozzles (5 pieces). Can be used between 60 and 100 Amp
ART1762	Ø 1,6 mm nozzles (5 pieces). Can be used between 100 and 120 Amp
ART1763	Ø 1,8 mm nozzles (5 pieces). Can be used between 120 and 160 Amp
ART1988	Shield
ART1876	Electrodes (5 pieces). Can be used between 20 and 160 Amp

CP161 PLASMA CUTTING TORCH SPARES - For Contact Cutting

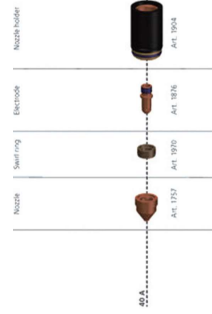

Part No. Description - Contact Cutting

ART1757	Ø 0,8 mm nozzles (5 pieces). Can be used between 20- 40 Amp. For thin sheet metal (0.5- 1.2 mm thickness)
ART1876	Electrodes (5 pieces). Can be used between 20-160 Amp
ART1904	Nozzle holder
ART1970	Swirl-Ring
ART1619	Brass cooling pipes (5 pieces)

Telephone: 01782 566553 Fax: 01782 566123

The Cebora Plasma Sound PC 10051/T is a 400v power source incorporating the very latest generator compatible inverter technology. This impressive industrial plasma cutter is supplied with the genuine Cebora CP161 hand torch allowing cutting on all metallic materials and benefits from high electromagnetic compatibility making it usable in the vicinity of sensitive electronic systems.

The Cebora plasma sound PC 10051/T is a highly efficient industrial power source and is the perfect solution to all heavy duty industrial applications.

Recommended	Maximum	Severance
Mild Steel	30mm	35mm 40mm

Technical Specification

Power Supply (+10%/-10%)	400V 3Ph
Fuses A	T20
Duty Cycle @ 50%	100A
Current Range	20- 100A
Operating Pressure	5 Bar
Protection Class	IP23S
Weight	34 Kg
Generator Friendly	Yes

PLASMA PROF 163 ACC

The Cebora Plasma Prof 163 ACC is a highly efficient power source incorporating the very latest "chopper" technology. The remarkable Cebora plasma Prof 163 ACC is supplied with the genuine Cebora CP161 hand torch. The power source also benefits from an exceptional duty cycle (160 amps @ 40%) and can be utilised for both hand held and automation applications.

The Cebora Plasma Prof 163 ACC plasma cutter is an unrivalled machine and allows a wide range of cutting and gouging applications in all industrial sectors.

Recommended	Maximum	Severance
Mild Steel	40mm	45mm 50mm

Technical Specification

Power Supply (+10%/-10%)	400V 3Ph
Fuses A	T40
Duty Cycle @ 40%	160A
Current Range	20- 160A
Operating Pressure	5 Bar
Protection Class	IP21S
Weight	140 Kg
Suitable for Gouging	Yes



PLASMA

CP161 PLASMA CUTTING TORCH SPARES - For Gouging

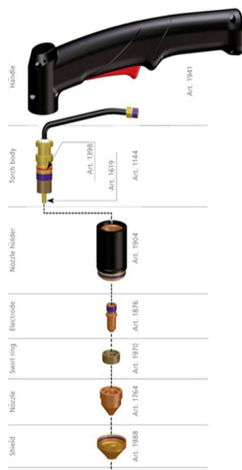

Part No.	Description
ART1144	Body for hand torches
ART1941	Handle assy
ART1398	O-rings (5 pieces)
ART1764	Ø 3 mm nozzles (5 pieces). For gouging.
ART1988	Shield
ART1878	Electrodes (5 pieces). Can be used between 20 and 160 Amp
ART1904	Nozzle holder
ART1970	Swirl-Ring
ART1619	Brass cooling pipes (5 pieces)

CP161 PLASMA CUTTING TORCH SPARES - For Automated Cutting

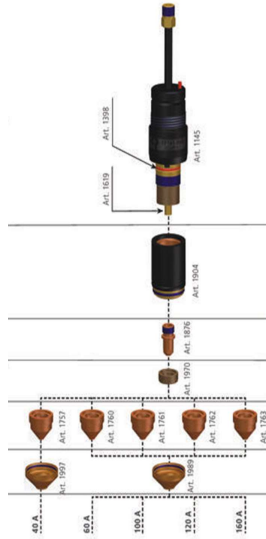

Part No.	Description	Part No.	Description
ART1229	Cebora CP161 DAR torch for profile machine with central adaptor. 4 m long (12 ft) Shielded. For HV 14 unit (art. 481). To be compulsorily coupled with art.108.	ART1761	Ø 1,4 mm nozzles (5 pieces). Can be used between 60 and 100 Amp
ART1231	Cebora CP161 DAR torch for profile machine with central adaptor. 6 m long (18 ft) Shielded.	ART1762	Ø 1,6 mm nozzles (5 pieces). Can be used between 100 and 120 Amp
ART1231.20	Cebora CP161 DAR torch for profile machine with central adaptor. 12 m long (36 ft) Shielded.	ART1763	Ø 1,8 mm nozzles (5 pieces). Can be used between 120 and 160 Amp
ART1145	Body for torches for profile machine	ART1689, 1697	Shield
ART1398	O-rings (5 pieces)	ART1876	Electrodes (5 pieces). Can be used between 20 and 160 Amp
ART1757	Ø 0,8 mm nozzles (5 pieces). Can be used between 20 and 40 Amp. For thin sheet metal (0,5 - 1,2 mm thickness).	ART1904	Nozzle holder
ART1760	Ø 1,2 mm nozzles (5 pieces) Can be used between 20 & 40 Amp	ART1970	Swirl-Ring
		ART1619	Brass cooling pipes (5 pieces)

E-mail: sales@weldfastuk.co.uk

Web: www.weldfastuk.co.uk



PLASMA

PLASMA SOUND PC 130/T

The Cebora Plasma Sound PC130T is a 400v power source incorporating the very latest generator compatible inverter technology. This excellent industrial plasma cutter allows cutting on all metallic materials and can readily be connected to an automated system. This machine is also supplied with the genuine Cebora CP162C hand torch and benefits from high electromagnetic compatibility allowing use in electronically sensitive areas.

The Plasma Sound PC130/T represents the very latest in plasma cutting innovation and is supplied with a highly visible LCD microprocessor for full adjustment of all parameters.

This technologically advanced power source is the ideal solution for a wide selection of industrial and fabrication applications.



Part No. ART 337

- Package Includes :**
- 6 Metre Cebora CP162C Plasma cutting torch (Art. 1631)
 - 6 Metre Earth Return
- Options :**
- 15 Metre CP162C Plasma cutting torch (Art. 1631.15)
 - 6 Metre CP162C Profile machine torch (Art. 1632)
 - 12 Metre CP162C Profile machine torch (Art. 1632.20)
 - Trolley (Art. 1656)

	Recommended	Maximum	Severance
Mild Steel	40mm	50mm	60mm

Technical Specification	
Power Supply	(+10%/-10%) 400V 3Ph
Fuses A	T32
Duty Cycle @ 100%	125A
Current Range	20 - 130A
Operating Pressure	5.5 Bar
Protection Class	IP23S
Weight	40 Kg
Generator Friendly	Yes

Telephone: 01782 566553 Fax: 01782 566123



PLASMA

CP162C PLASMA CUTTING TORCH SPARES - For Manual Cutting

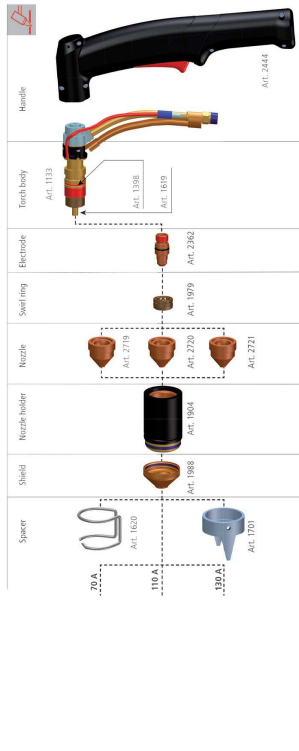

Part No.	Description - Manual Cutting
ART1133	Body for hand torches
ART2444	Handleassy
ART1398	O-rings (5 pieces)
ART2719	Ø 1,35 mm nozzles (5 pieces), Can be used between 51- 70 Amp
ART2720	Ø 1,5 mm nozzles (5 pieces), Can be used between 71- 110 Amp
ART2721	Ø 1,65 mm nozzles (5 pieces), Can be used between 111- 130 Amp
ART1988	Shield

Part No.	Description - Manual Cutting
ART2362	Electrodes (5 pieces), Can be used between 20- 130 Amp
ART1904	Nozzle holder
ART1979	Swirl-Ring
ART1619	Brass cooling pipes (5 pieces)
ART1620	Spacing Springs (5 pieces)
ART1701	Spacing bushes with 2 points (3 pieces)
ART407	Wheeled compasses for hand torches
ART406	Wheeled torch holder

CP162C PLASMA CUTTING TORCH SPARES - For Contact Cutting

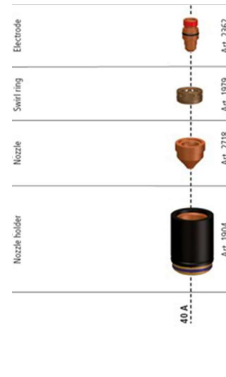

Part No.	Description - Contact Cutting
ART2718	Ø 0,9 mm nozzles (5 pieces), Can be used between 20- 50 Amp
ART2362	Electrodes (5 pieces), Can be used between 20- 130 Amp
ART1904	Nozzle Holder
ART1979	Swirl Ring

CP162C PLASMA CUTTING TORCH SPARES - For Gouging



Part No.	Description - For Gouging
ART2722	Ø 3,1 mm nozzles (5 pieces), For Gouging
ART1988	Shield
ART2362	Electrodes (5 pieces), Can be used between 20- 130 Amp
ART1904	Nozzle Holder
ART1979	Swirl Ring

E-mail: sales@weldfastuk.co.uk

Web: www.weldfastuk.co.uk

Telephone: 01782 566553 Fax: 01782 566123



spot/stud welders

SPOT 2500

The Cebora Spot 2500 is a compact 230V/400V power source ideal for applications in the automotive repair industry. The Cebora Spot 2500 utilises a digital panel with synchronous control and electronic adjustment allowing the operator to select an extensive range of studs, rivets and washers for single or multiple pulling repairs on steel, galvanised and High strength materials.

This machine is complemented by the large number of manufacturers approvals and is the perfect solution for rapid panel repair in the automotive sector.



Part No. ART 2148.18 (230V)
Part No. ART 2148 (400V)

Package Includes :
2 Metre Earth Return
2.5 Metre cable with Spot Gun
Multi-purpose slide hammer
Box of assorted accessories

Technical Specification	
Power Supply (+10%/-10%)	230V / 400V 1Ph
Fuses A	T10
Current Range	3000A Max.
Protection Class	IP23S
Weight	30 Kg

Options :
Trolley (Art 1653)
Sliding hammer with hand grip (Art 2290)
Hammer Head for washer traction (Art 2293)
Hammer Head for Pin extraction (Art 2295)
Spot weld electrode for 3mm & 5mm rivets (Art 2296)
Spot weld electrode for washers (Art 2297)
Spot weld electrode for M4 screws and 2mm & 2.5mm Pins (Art 2298)

POWER SPOT 5700

The Power Spot 5700 Aluminium is a latest technology 110V/230v capacitor discharge stud welder. The technical features of this machine offer the ideal solution for applications within the high quality automotive repair industry. This exceptional machine allows the fixing of studs, washers and rivets up to M8 diameter on wide variety of materials including Aluminium, Stainless steels, high strength steels and galvanised steels etc. This machine produces unrivalled mechanical and cosmetic results and benefits from an intuitive, operator friendly LCD control panel giving access to the full range of parameter adjustment features.

The Power Spot 5700 is complemented by the large number of leading vehicle manufacturers approvals.



Part No. ART 2156

Package Includes :
Stud Gun
Double Earth Return

Technical Specification	
Power Supply (+10%/-10%)	110V / 230V 1Ph
Fuses A	T16 / T10
Stud Range	M3 - M8
Protection Class	IP23S
Weight	15 Kg

Options :
Trolley (Art 1653), 3 Pin Spacer (Art 2334)
M3 Stud Holder (Art 2343), M4 Stud Holder (Art 2344)
M5 Stud Holder (Art 2345), M6 Stud Holder (Art 2346)
M8 Stud Holder (Art 2348)